

# VehicleBreathalyzer

## Operating Manual

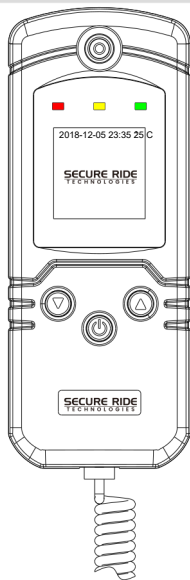

# Directory

Product Introduction .....	01
Testing preparation .....	01
Power .....	01
Component Description .....	02
Operating instructions .....	03
Memory query .....	05
Time set .....	06
Standby mode .....	07
SOS .....	08
Important notes .....	09
Accessories .....	09
Fault Description .....	10
Correction Record .....	11
Specification .....	12
Warranty .....	13
Precautions .....	14

## **Product Introduction**

- This product is used to measure the alcohol content of exhaled gases in the human body. The measurement results of the product are used to determine whether you are drinking alcohol.

The product is equipped with a control system. When the alcohol content of the exhaled gas exceeds the set threshold, the vehicle connected to the control system will not be able to start. Only when the alcohol content of the exhaled gas does not exceed the set threshold, the vehicle connected to the control system can start and drive normally.

- The measurement range of the product is 0.00 ‰ to 4.00 ‰ BrAC exhaled gas alcohol concentration. Exhaled gas with an alcohol content greater than 4.00 ‰ indicates HI in BrAC products.

## **Testing preparation**

- Do not eat or drink 15 minutes before conducting the test.
- Operation: -10°C ~ 50°C or 14°F ~ 122°F

## **Power**

- The product uses a car mounted power supply with a wide voltage range of DC 9V to 36V.

## Component Description

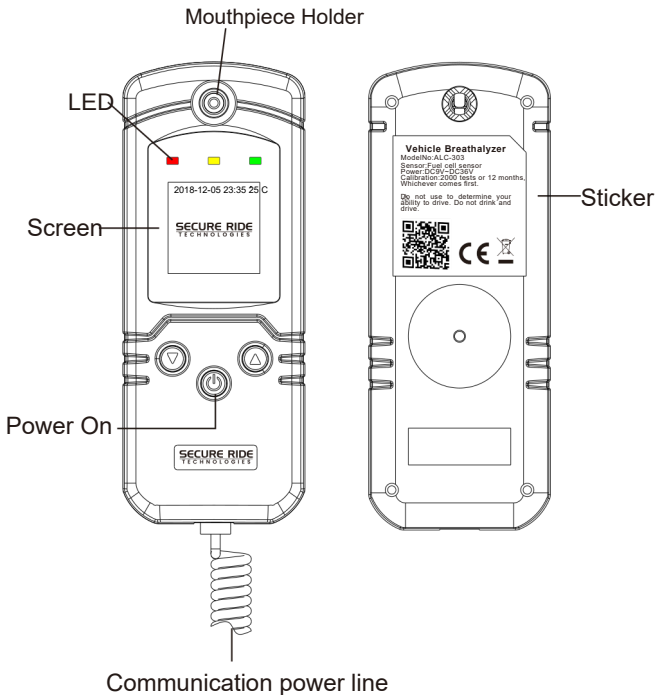

## Operating instructions

### Testing preparation

- Insert the Mouthpiece into the blowing tube .

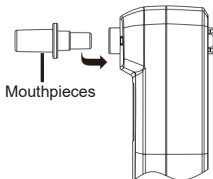

- Press the power button until the screen turns on, then release.



- The usage count (number of blows) is displayed then a countdown.

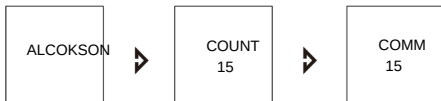

The device displays "COMM" and starts a 15 second countdown. When the countdown is complete, the screen displays "Blowing" to prompt the tested person to blow air for testing.

When the alcohol tester successfully interacts with a third-party integrated system, the screen will prompt "Blowing", start blowing into the mouthpiece. After successful blowing, the animated hourglass on the screen will rotate to indicate that the system is calculating. After the calculation is completed, the test result will be displayed. When the test result exceeds the alarm point, the alcohol tester indicator light will turn red and give an alarm. If the alarm is not exceeded, the green light will turn on and not give an alarm.

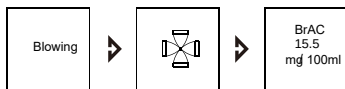

When the test result does not exceed the set threshold, the driver can start the vehicle to drive. When the test result exceeds the set threshold, the vehicle connected to the device will not be able to start driving.

During the blowing process, if the user fails to blow or does not meet the requirements, if the blowing is interrupted or the flow rate is too low, the device will prompt "Blow fail" and wait for 5 seconds before automatically entering standby mode. The user can press and hold the power button to enter the testing state again.



## Memory Query

After the test is completed, when the screen displays the test result value, press the power button to enter the memory query mode. After entering, press the left or right button, and each press will display a set of test records. At most, the last 50 tests can be viewed.



## Time set

Press the left button first, then press the power button at the same time until the startup is completed and enter the clock setting interface. Use the left and right buttons to adjust time. The power button is for mode switching, and you can choose year, month, day, hour, and minute to switch settings until you set the clock. When finished, wait for the device to power off to enter normal operation again.

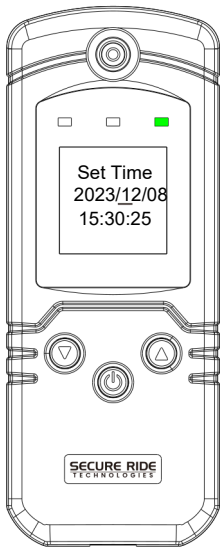

## Standby mode

When the test results are completed after 60 seconds the screen displays "Stand by". In this mode, long press the power button to initiate another test if desired.

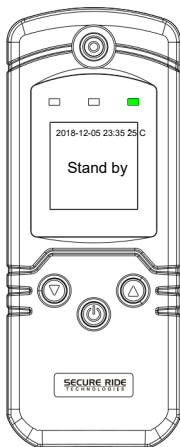

# SOS

Emergency Bypass Mode Press and hold the left and right buttons of the alcohol tester to enter the blowing mode when it is turned on. Enter the password "██████" on this interface and wait for 5 seconds before the yellow light stays on and the screen displays the SOS and effective time. The effective time of SOS is 72 hours.

**NOTICE:**  
***ONCE SOS EXPIRES THE ALCOHOL TESTER NEEDS TO BE SENT IN FOR DEVICE SERVICE, IT WILL NOT OPERATE AGAIN UNTIL RECALIBRATION IS COMPLETED.***



## **Important notes**

- Wait at least 15 minutes after eating or drinking .
- T h e b l o w i n g t i m e m u s
- I ERR (error) if shown not sufficient blowing duration or interrupted blowing
- If the device changes temperature suddenly, wait some minutes to use.
- Only use the device in a temperature -10°C -50°C or 14°F -122°F.
- Recalibration cycle: 12 months or 2000 tests.
- Never store the device in a corrosive gas room.
- Never store the device under direct sun exposure.
  
- Do not drop the Alcohol Tester.

## **Accessories**

- Mouthpieces
- Manual
- Alcohol Tester Mount

## Fault Description

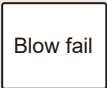
Error Message or Troubles	Description	Notes
No Display	<ul style="list-style-type: none"> <li>- Press and hold the TEST button until power on</li> <li>- Check the power</li> </ul>	
Auto Off	<ul style="list-style-type: none"> <li>- Over the period of test stage Vehicle not powered on</li> </ul>	
HI	<ul style="list-style-type: none"> <li>-The test result exceeds the display range</li> <li>-Display range: 0.400% BAC</li> </ul>	
Blow fail	<ul style="list-style-type: none"> <li>- Blowing unsteady or interrupt</li> <li>- Blowing less than 6 seconds</li> <li>- Blowing flow too weak</li> <li>- No blow during BLOW mode</li> <li>- Change temperature suddenly</li> </ul>	
Alarm	<ul style="list-style-type: none"> <li>-Reminder of blowing process</li> <li>-Error reminder</li> <li>-Exceeding the alarm point</li> </ul>	
Power on yellow light	<ul style="list-style-type: none"> <li>- The device has reached the calibration cycle</li> <li>- Calibration Reminder</li> </ul>	Please contact the service provider for calibration services

## Specification

- Electrochemical sensor (Fuel Cell Sensor)
- Blowing time about 6 seconds
- Blowing flow about 10L/min
- Blowing flow interrupt detection
- Test counter to display the operated number
- 240 \* 240TFT color display screen 1.54 inches
- Display range: 0.00-0.20%BAC(2.00‰ or 1.00mg/L)
- Show “HI” if above the display range
- Accuracy: +/-0.05‰ at 0.50‰
- Memory: 10 last records
- 5 mouthpieces included
- Warm up time: 10-15 seconds
- Testing Time: 10 seconds
- Repeat test: less than 60 seconds.
- Exceeding the alarm point will emit an alarm sound and change the color of the indicator light
- Selective alarm point for 0.02%, 0.05% or 0.08%
- Selective unit of measure for %, ‰, mg/L
- Power supply: DC9-36V on-board power supply
- Operation: -10°C ~ 50°C or 14°F ~ 122°F
- Storage temperature: -20°C ~ 60°C or -4°F~140°F
- Size: 140x55x27mm

# Warranty

## ONE-YEAR LIMITED WARRANTY

We warrant this unit to be free from defects in workmanship or material under normal use for warranty period ONE (1) YEAR from the date of retail purchase.

The warranty period does not include the recalibration service. The warranty covers parts and labor on covered repairs and ground freight back to the local customer.

If a defect arises and we receive a valid claim within the Warranty Period, at its option, we will either:

1. Repair the unit,
2. Exchange the unit, which is new or used functionally equivalent to the original unit,
3. Refund the purchase price of the unit.

For warranty service please follow these instructions:

1. Call or email your distributor to obtain an RMA number.
2. Return the unit postage paid, insured and in a proper box.
3. You should obtain a proof of delivery receipt, and must pay the cost for shipping to us.
4. You must enclose the following with the unit:
  - a. The completed RMA form and description of the problem.
  - b. Your name, return address (Not PO Box)
  - c. Your phone number.
  - d. A copy of your sales receipt or invoice.

## Precautions

- Your blood alcohol content (BAC) may change some minutes later.
- Calibrate the product every 12 months or 2000 uses, otherwise the data may be inaccurate. (The product is counted as 2000 automatic reminder calibrations).
- Do not use this device to determine if you can drive.
- You cannot use the test results of device in court of law.



